

BD 10/10 EEC (251379261C180)

GENERAL DATA



DOUBLE INLET CENTRIFUGAL FAN WITH ELECTRONIC MOTOR EEC

MANUFACTURING FEATURES

- Galvanised steel sheet housing.
- Polyamide impeller reinforced with fibreglass in models 7/7, 9/9, 10/10 and 12/12. Galvanised steel sheet impeller for all range.
- Double inlet forward curved impeller.
- Supplied with mounting feet (included in price).
- Motor fixing with an exclusive system designed by Casals through flexible arms and silent blocks to avoid vibration. Flexible arms in compliance with the ROHS 2002/95/EC Directive (Restriction of the Use of Certain Hazardous Substances in Electrical and Electronic Equipments).
- PM brushless motor (permanent magnets), synchronous, electronically commutated, high efficiency and low sound level. Specially designed for fans with electronic operation and control in deported box IP65.

Working range: from 400 to 1200-2000rpm (depending on the models)

Motor with IP54 protection and class F insulation. IP 65 drive case

Power: 220V ± 10% single phase

Power frequency: 50 / 60Hz

Operating temperature range: -20°C to 50°C

Speed control through signal 0-10V or PWM

APPLICATIONS

Designed for assembly in equipment:

- Ventilation boxes and air handling units.
- Centrifugal heaters.
- Industrial and professional kitchen hoods.
- Maximum working temperature: 50°C.

UNDER REQUEST

- Galvanized sheet impeller
- MBI assembled

PERFORMANCE CURVE

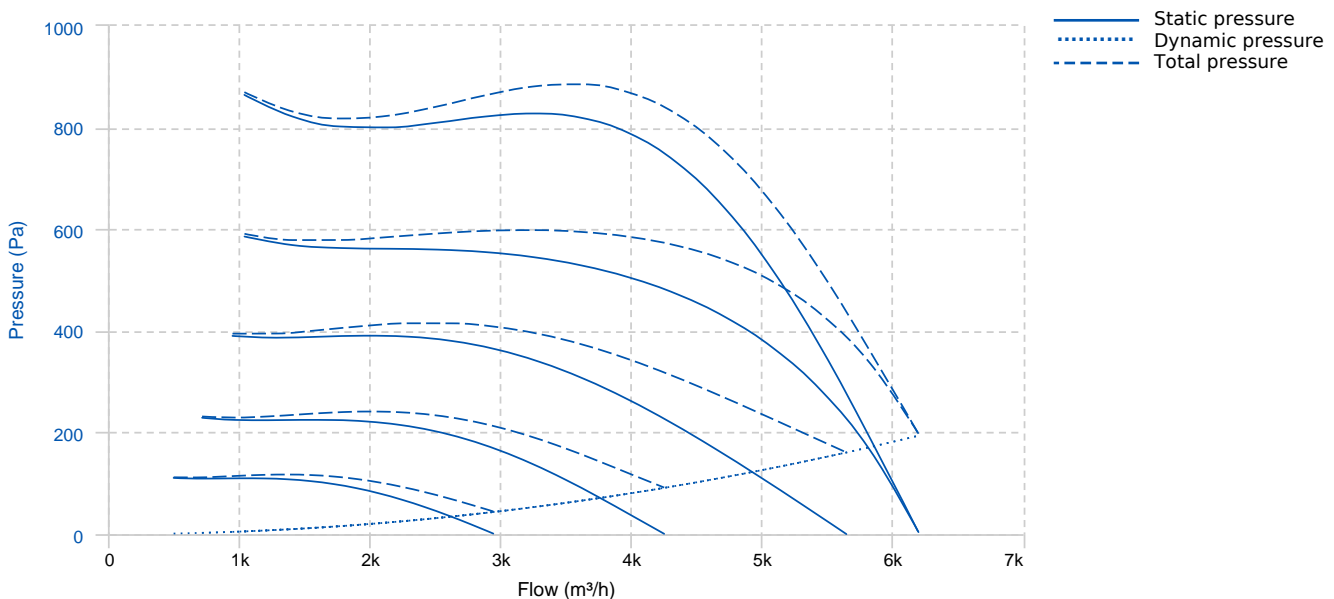

TECHNICAL DATA

Fan							
RPM	1800	Approx. weight	21 kg	Max. Flow	6200 m ³ /h		
Motor							
Power	1,5 kW	RPM	1800 (max)	I max. (230V)	10 A	Approx. weight	0 kg

ERP DATA

Fan data sheet		
Fan type	Centrifugal fan radial or forward blades	
Installation category	B: Inlet free, Ducted outlet	
Efficiency category	Total	
The fan has to be installed with VF	No	
Motor power (kW)	1.5	
	Fan values	ERP Requirements 2015
Max. efficiency (%)	57.19	43.9
Efficiency grade (N)	62.29	49
Pabs (kW)	1.569	
Flow (m ³ /h)	3564.11	
Total pressure (Pa)	885.91	
Speed (m/s)	1800 (10V)	
Specific ratio	1.01	

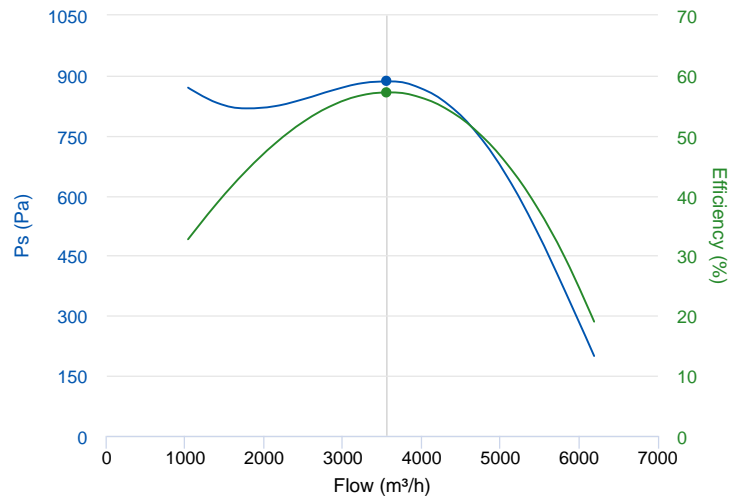

DIMENSIONS

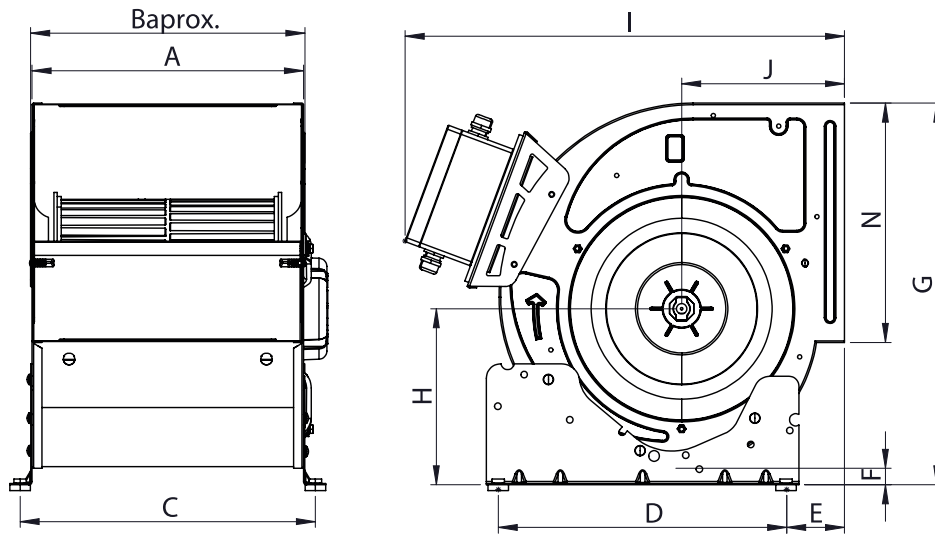

Dimensions (mm)

A	329	B	343	C	359	D	350	E	70.5
F	20	G	464	H	214	I	534	J	198
N	291								

WIRING DIAGRAM

MOTOR OUTPUT SALIDA MOTOR

The EC motor is three phase and the output of three phases is connected in this connection terminal.
El motor EC es trifásico y la salida de las 3 fases del mismo se conectan a este terminal de conexión.

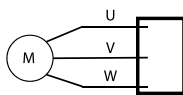

POWER INPUT (230V) ENTRADA DE ALIMENTACIÓN (230V)

In this other terminal, the power input must be connected with the L (line), N (neutral) and single phase PE (ground).
En este otro terminal se debe conectar la entrada de alimentación con la L (línea), N (neutro) y PE (tierra) monofásica.

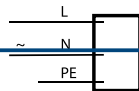

CONTROL: 0-10 INPUT CONTROL: 0-10 ENTRADA

The fan is adjustable in rpm and has a variable input from 0 to 10V.
You can connect any accessory or external device that gives this variable signal (for example: temperature sensor, inverter, etc.). In case you want to operate the fan at maximum revolutions, you should connect VSP (0-10V) and +12 directly.
El ventilador es regulable en RPM y tiene una entrada variable de 0 a 10V.
Se puede conectar algún accesorio o dispositivo externo que dé esta señal variable (por ejemplo, sensor de temperatura, variador, etc.). En caso de que se quiera hacer funcionar el ventilador a máximas revoluciones se debe conectar directamente VSP (0-10V) y +12.

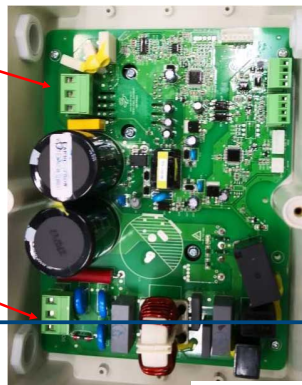
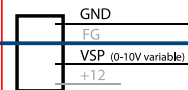

ACCESSORIES



**SAFETY SWITCH
INT 25 3P A
REF: INT253PA**



**OUTLET PROTECTION GUARD FOR FANS
RI 10/10
REF: 960000406**



PROTECTION GRID FOR BD FANS, MOTOR SIDE
RM 10 (T80)
REF: 960000804



OUTLET FLANGE FOR BD AND BV FANS
MBI 10/10
REF: 251371691



INLET PROTECTION GUARD FOR CENTRIFUGAL FANS
RA 10
REF: 960650100



SPEED CONTROLLER FOR EEC MOTOR
REGC
REF: FX263300

SPARE PARTS

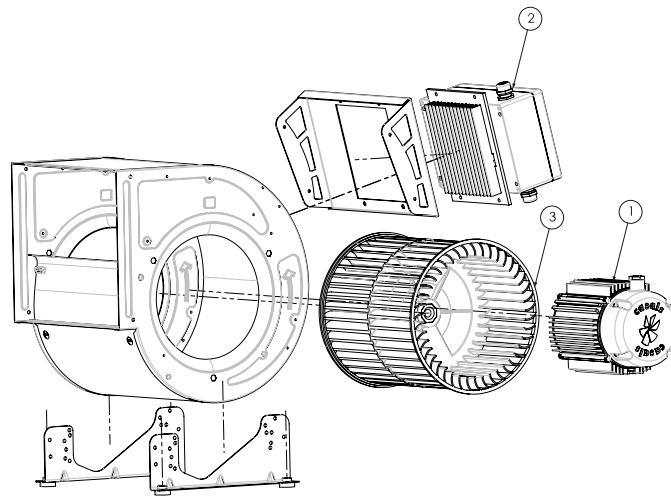

	Code	Model	Qty
1	301002200LP4	MOTOR EEC1500 LP Ø1/2"	x1
2	301002204R180	ELECTRONICAL DEVICE EEC1500 1800RPM	x1
3	251379383	TURBINE PA6 BD10/10	x1