

HJBM 40 0,37kW EEC (1500rpm) (268401103)

GENERAL DATA



WALL MOUNTED FAN WITH SQUARE FRAME, VARIABLE PITCH BLADES AND ELECTRONIC MOTOR

MANUFACTURING FEATURES

- Square plate made of galvanized steel sheet.
- Variable pitch angle polyamide impeller reinforced with fibreglass.
- Supplied with motor support and protection guard according to the ROHS 2002/95/EC Directive (Restriction of the Use of Certain Hazardous Substances in Electrical and Electronic Equipments).
- PM brushless motor (permanent magnets), synchronous, electronically commutated, high efficiency and low sound level. Specially designed for fans with electronic operation and control in deported box IP65.

Working range: from 400 to 1200-2000rpm (depending on the models)

Motor with IP54 protection and class F insulation. IP 65 drive case

Power: 220V ± 10% single phase

Power frequency: 50 / 60Hz

Operating temperature range: -20°C to 50°C

Speed control through signal 0-10V or PWM

APPLICATIONS

Designed for wall assembly, they are suitable for:

- Air renewal for all kind of buildings and industries.

UNDER REQUEST

- B form impeller (air flow from impeller to motor).
- Aluminium impeller.

PERFORMANCE CURVE

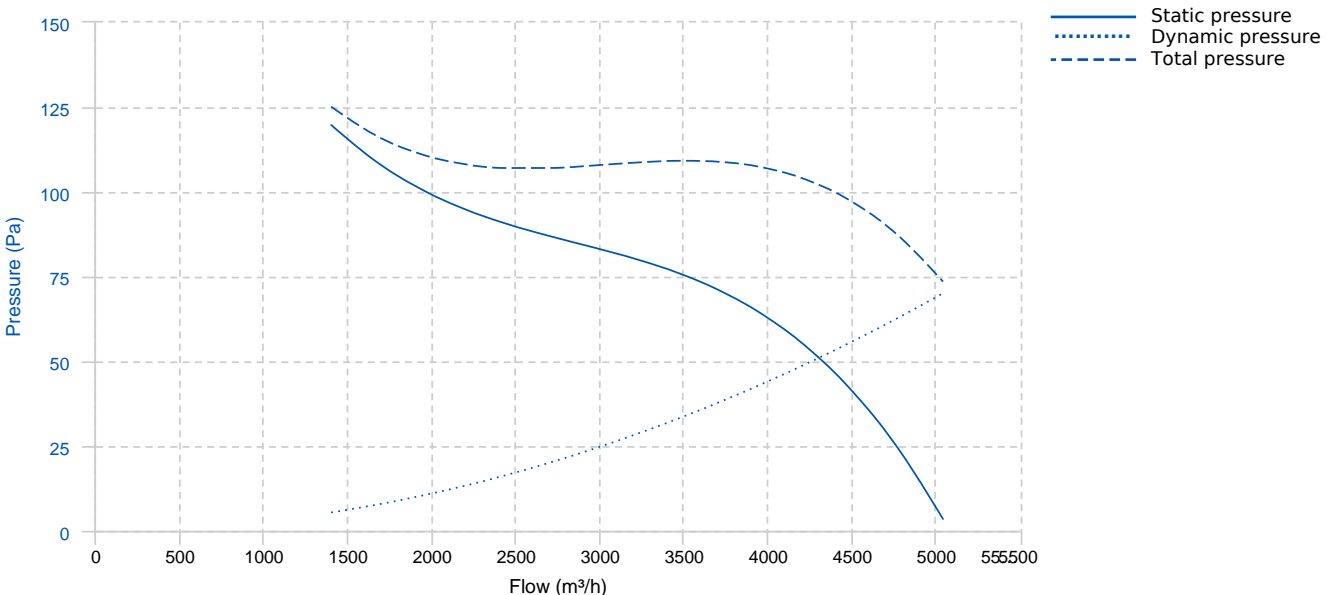

TECHNICAL DATA

Fan							
RPM	1500	Approx. weight	9 kg	Max. Flow	5040 m ³ /h		
Motor							
Power	0,37 kW	RPM	1500	I max. (230V)	5 A	Approx. weight	0 kg

ERP DATA

Fan data sheet		
Fan type	Axial fan	
Installation category	A: Outlet and Inlet free discharge	
Efficiency category	Static	
The fan has to be installed with VF	No	
Motor power (kW)	0.37	
	Fan values	ERP Requirements 2015
Max. efficiency (%)	38.8	29.22
Efficiency grade (N)	49.58	40
Pabs (kW)	0.197	
Flow (m ³ /h)	3246.54	
Static pressure (Pa)	79.7	
Speed (m/s)	1500	
Specific ratio	1.00	

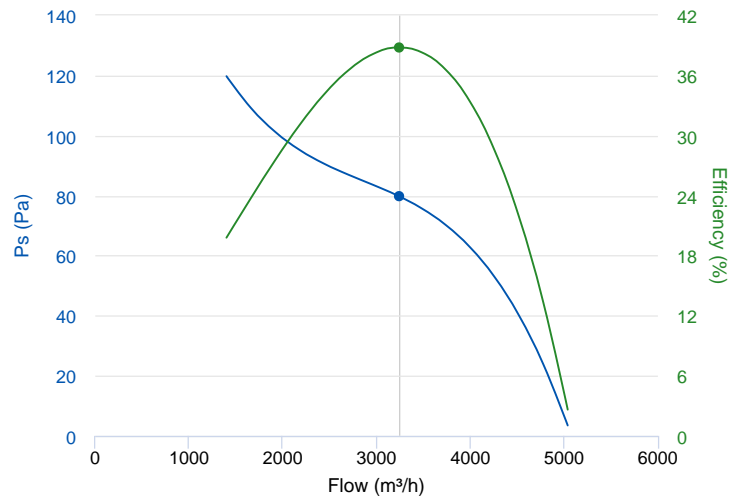

DIMENSIONS

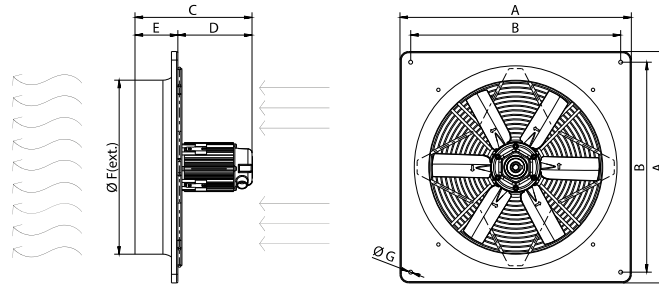

Dimensions (mm)

A	540	B	490	C	274	D	174	E	100
ØF	406	ØG	9						

WIRING DIAGRAM

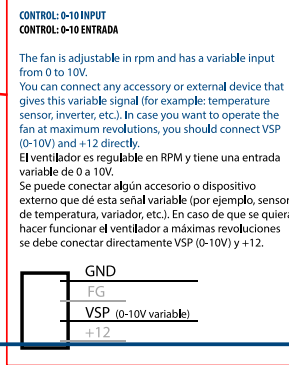
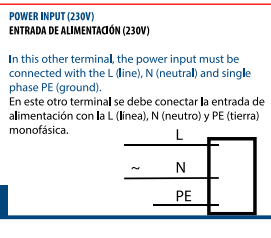
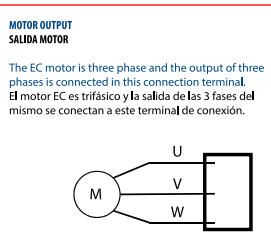

ACCESSORIES



SAFETY SWITCH
INT 25 3P A
REF: INT253PA



Outlet protection guard for axial fans
RPO 40
REF: 980000040



PLASTIC GRAVITY SHUTTER
PCP 40
REF: 963230106



SPEED CONTROLLER FOR EEC MOTOR
REGC
REF: FX263300



ALUMINIUM GRAVITY SHUTTER
PC2 40
REF: PC24040

SPARE PARTS

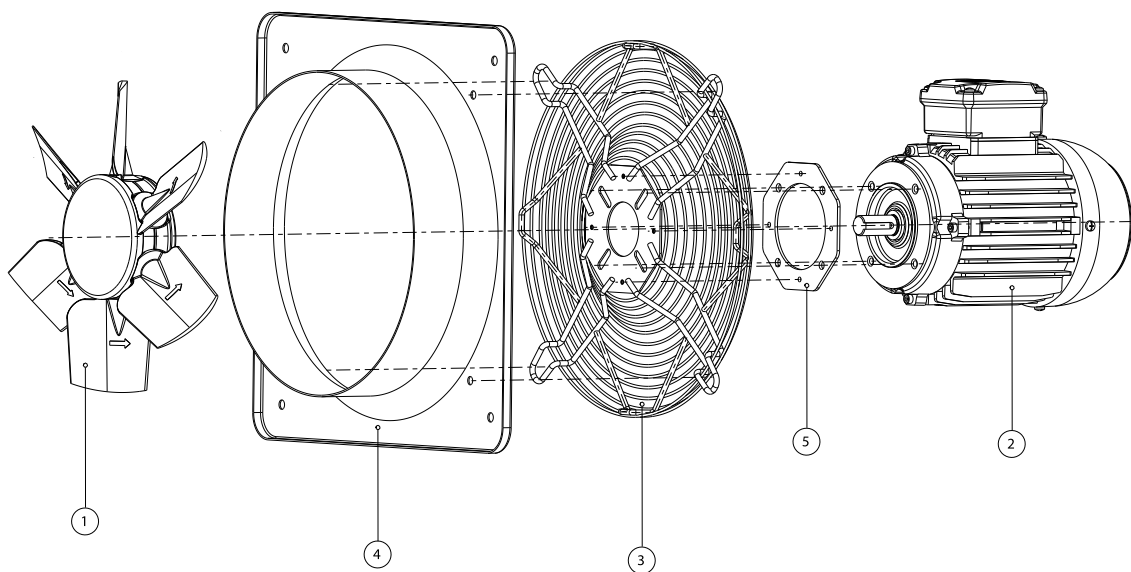

	Code	Model	Qty
1	H40006335PSTD	IMPELLER 400:AP0:6 G35 D19	x1
2	301002000IEC4	MOTOR EEC0,37kW	x1
3	268401907	PROTECTION GRID HJBM EEC40	x1